

# Timing Belt: Service and Repair

## COMPONENT

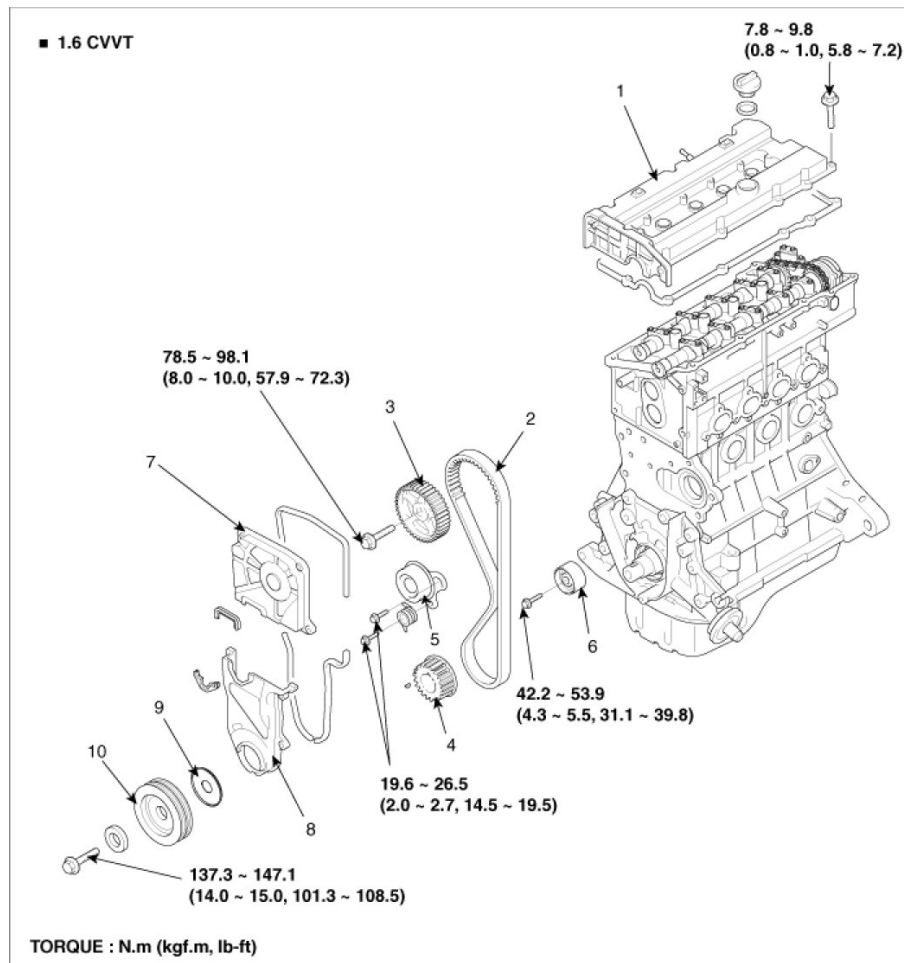

1. Cylinder head cover
2. Timing belt
3. Camshaft sprocket
4. Crankshaft sprocket
5. Tensioner

6. Idler
7. Timing belt upper cover
8. Timing belt lower cover
9. Flange
10. Crankshaft pulley

## REMOVAL

Engine removal is not required for this procedure.

1. Remove the engine cover(A).

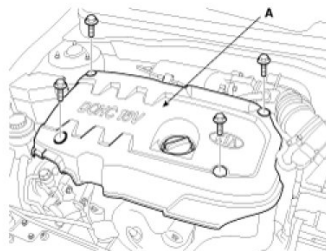

2. Remove the RH front wheel.
3. Remove the 2 bolts(B) and RH side cover(A).

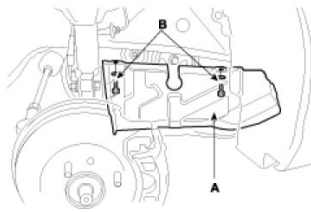

4. Temporarily loosen the water pump pulley bolts.

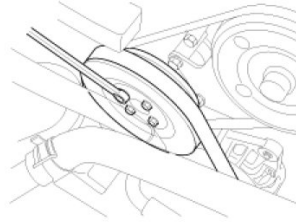

5. Remove the alternator drive belt(A).

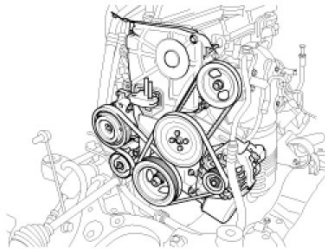

6. Remove the air conditioner compressor drive belt(B).  
(Refer to HA group - air conditioner compressor)
7. Remove the power steering pump drive belt(C).  
(Refer to ST group - power steering pump)
8. Remove the 4 bolts and water pump pulley.
9. Remove the 4 bolts(B) and timing belt upper cover(A).

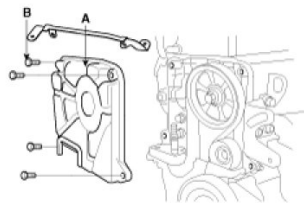

10. Turn the crankshaft pulley, and align its groove with timing mark "T" of the timing belt cover. Check that the timing mark of camshaft sprocket is aligned with the timing mark of cylinder head cover. (No.1 cylinder compression TDC position)

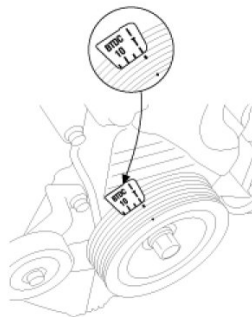

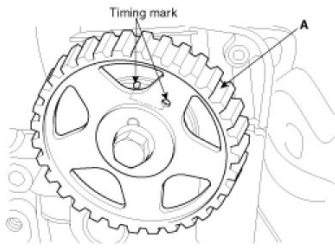

11. Remove the crankshaft pulley bolt and crankshaft pulley(A).

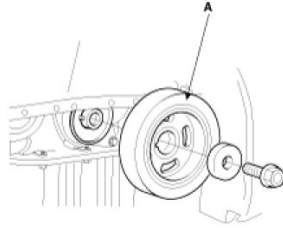

12. Remove the crankshaft flange(A).

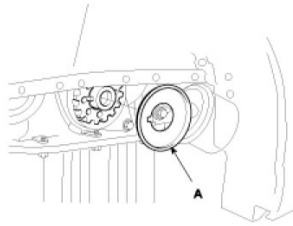

13. Remove the 4 bolts(B) and timing belt lower cover(A).

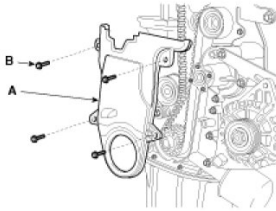

14. Remove the timing belt tensioner(A) and timing belt.

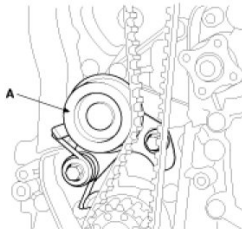

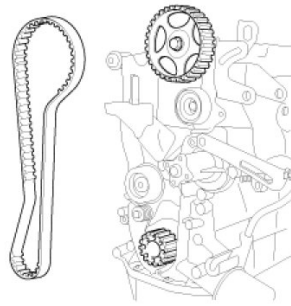

**NOTE:**  
If the timing belt reused, make an arrow indicating the turning direction to make sure that the belt is reinstalled in the same direction as before.

15. Remove the bolt(B) and timing belt idler(A).

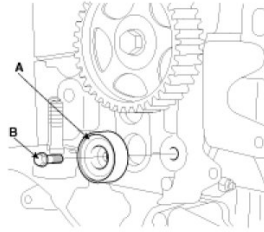

16. Remove the crankshaft sprocket(A).

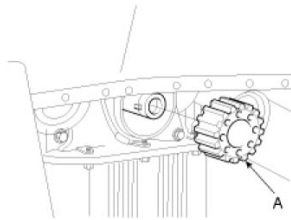

17. Remove the cylinder head cover.  
(1) Remove the wire harness bracket(A).

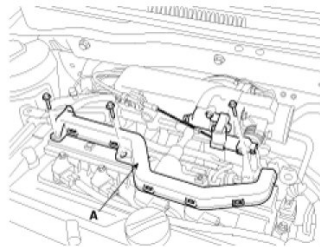

- (2) Remove the ignition coil.

■ 1.6 CVT

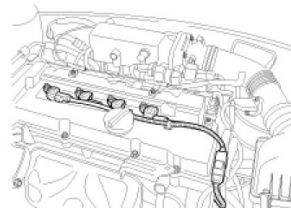

- (3) Remove the PCV (Positive Crankcase Ventilation) hose(A) and the breather hose(B) from the cylinder head cover.

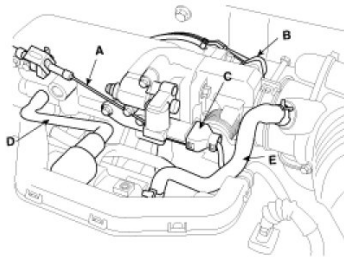

(4) Remove the engine cover bracket(A).

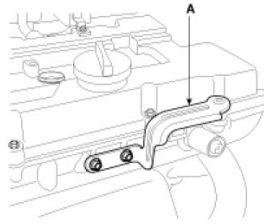

(5) Loosen the cylinder head cover bolts(B) and then remove the cover(A) and gasket.

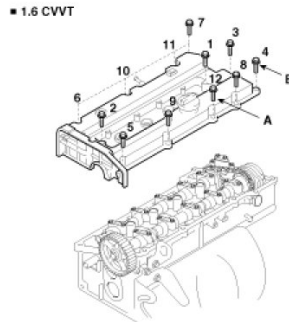

18. Remove the camshaft sprocket.

(1) Hold the portion(A) of the camshaft with a hexagonal wrench, and remove the bolt(C) with a wrench(B) and remove the camshaft sprocket.

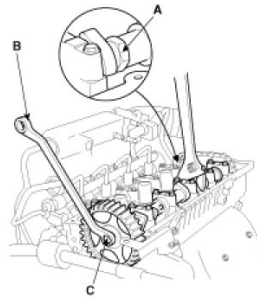

**CAUTION:**

Be careful not to damage the cylinder head and valve lifter with the wrench.

**INSTALLATION**

1. Install the camshaft sprocket and tighten the bolt to the specified torque.

(1) Temporarily install the camshaft sprocket bolt(C).

(2) Hold the portion(A) of the camshaft with a hexagonal wrench, and tighten the bolt(C) with a wrench(B).

**Tightening torque : 78.5 - 98.1N.m (8.0 - 10.0kgf.m, 57.9 - 72.3lb-ft)**

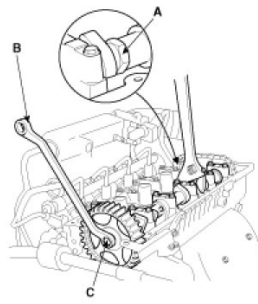

2. Install the cylinder head cover.

(1) Install the cylinder head cover(A) and bolts(B).

**Tightening torque : 7.8 - 9.8N.m (0.8 - 1.0kgf.m, 5.8 - 7.2lb-ft)**

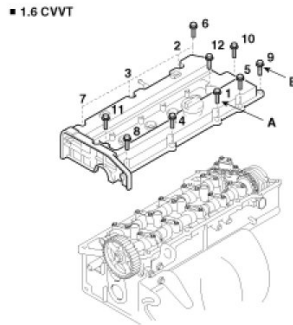

(2) Install the engine cover bracket(A).

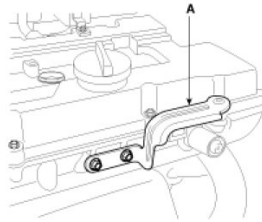

(3) Install the PCV(Positive Crankcase Ventilation) hose(A) and breather hose(B) to the cylinder head cover.

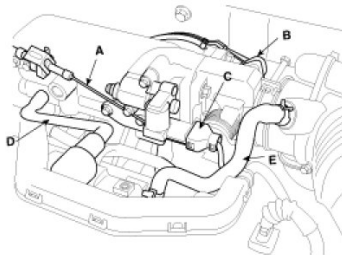

(4) Install the ignition coil.

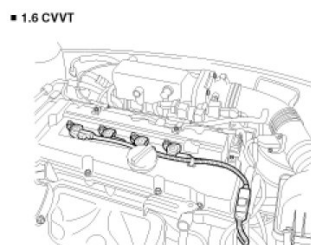

3. Install the crankshaft sprocket(A).

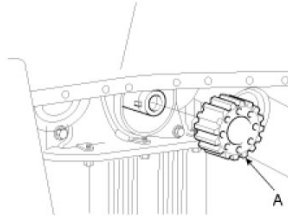

4. Align the timing marks of the camshaft sprocket(A) and crankshaft sprocket(B) with the No.1 piston placed at top dead center and its compression stroke.

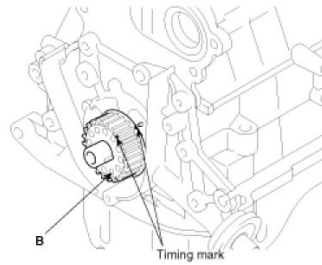
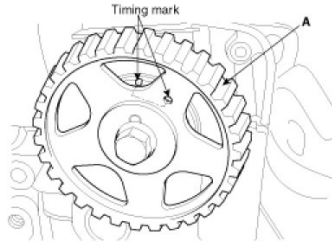

5. Install the idler pulley(A) and tighten the bolt(B) to the specified torque.

**Tightening torque : 42.2 - 53.9N.m (4.3 - 5.5kgf.m, 31.1 - 39.8lb-ft)**

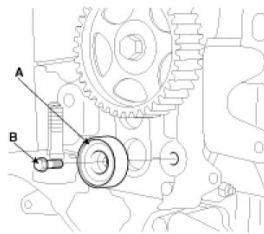

6. Temporarily install the timing belt tensioner(A).

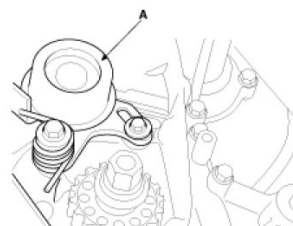

7. Install the belt so as not give slack at each center of shaft. Use the following order when installing timing belt.  
Crankshaft sprocket(A) ->idler pulley(B) ->camshaft sprocket(C) ->timing belt tensioner(D).

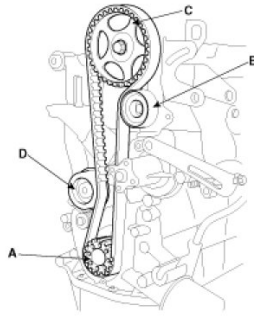

8. Adjust the timing belt tension.

- (1) Loosen the tensioner pulley mounting bolt and apply tension to the timing belt.

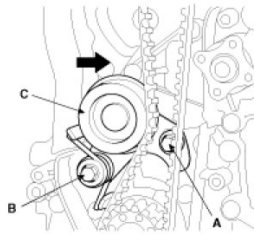

- (2) After checking the alignment between each sprocket and each timing belt tooth, tighten the mounting bolt (A) and (B) one by one.

**Tightening torque : 19.6 - 26.5N.m (2.0 - 2.7kgf.m, 14.5 - 19.5lb-ft)**

- (3) Then recheck the belt tension.

Verify that when the tensioner and the tension side of the timing belt are pushed in horizontally with a moderate force [approx. 49N (11lb)], the timing belt cog end is approx. 1/2 of the tensioner mounting bolt head radius (across flats) away from the bolt head center.

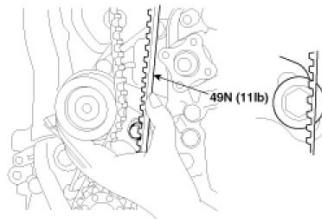

- (4) Timing belt tension measuring procedure  
(by a sonic tension gauge)

Rotate crankshaft in clockwise direction to set 1st piston on top dead center (TDC) and rotate crankshaft in counterclockwise to 90° then measure the belt tension in the middle of tension side span (in arrow direction of above illustration) by free vibration method.

**CAUTION:**

Avoid rotating the crankshaft in a counter clockwise direction.  
Engine damage could occur.

**Conversion equation of frequency into tension :  $T = (4 / 9.8) \times S^2 \times M \times W \times f^2 / 100000000$  S : Measured belt span (mm) / M : Unit weight of belt (gf/cm<sup>2</sup>) / W : Belt width (mm) f : Transverse natural frequency of belt (Hz)**

**Timing Belt Specifications**



Item	Specifications
S (mm)	249.6
M (gf/cm <sup>2</sup> )	0.4543
W (mm)	22
f (Hz)	70.4 - 87.9
T (kgf)	16 ± 3.5

9. Turn the crankshaft two turns in the operating direction (clockwise) and realign crankshaft sprocket and camshaft sprocket timing mark.
10. Install the timing belt lower cover(A) with 5bolts(B).

**Tightening torque : 7.8 - 9.8N.m (0.8 - 1.0kgf.m, 5.8 - 7.2lb-ft)**

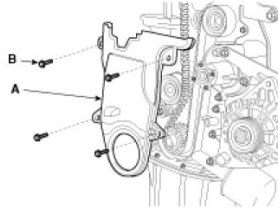

11. Install the flange and crankshaft pulley(A), and then tighten crankshaft pulley bolt. Make sure that crankshaft sprocket pin fits the small hole in the pulley.

**Tightening torque : 137.3 - 147.1N.m (14.0 - 15.0kgf.m, 101.3 - 108.5lb-ft)**

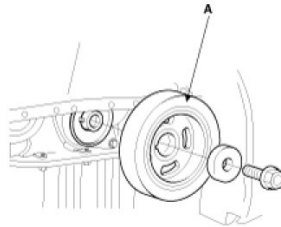

12. Install the timing belt upper cover(A) with 4 bolts(B).

**Tightening torque : 7.8 - 9.8N.m (0.8 - 1.0kgf.m, 5.8 - 7.2lb-ft)**

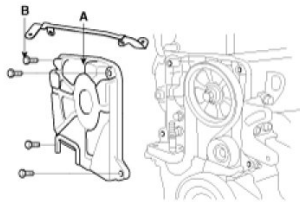

13. Install the water pump pulley and 4 bolts.
14. Install the power steering pump drive belt(C).

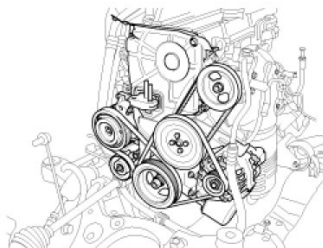

15. Install the air conditioner compressor drive belt(B).

(Refer to HA group - air conditioner compressor)

16. Install the alternator drive belt(A).

17. Install the RH side cover(A) with 2 bolts(B).

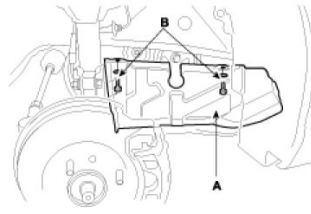

18. Install the RH front wheel.

**Tightening torque : 88.3 - 98.1N.m (9.0 - 10.0kgf.m, 65.1 - 72.3lb-ft)**

19. Install the engine cover with bolts.

**Tightening torque : 3.9 - 5.9N.m (0.4 - 0.6kgf.m, 2.9 - 4.3lb-ft)**

